

# **Adaptable Airplane Seat Device (AASD)**

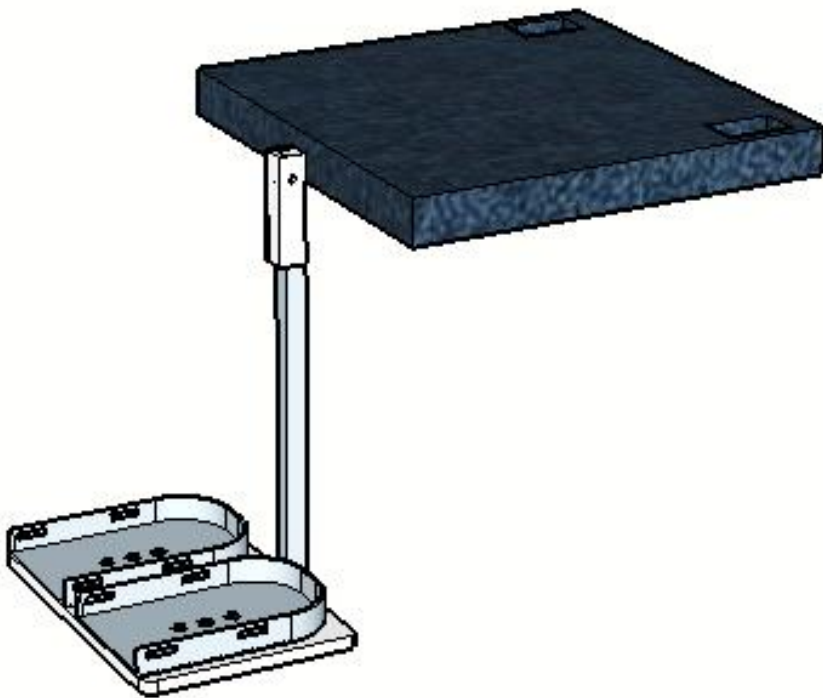

**User's Manual**

The AASD (Adaptable Airplane seat device) is a device designed to facilitate travel for people who experiment spastic movements.

The AASD can be used in many airplane lines. FAA regulations and standard airplane measurements were taken into consideration when designing this device.

This device's assembly and mount require strength and fine motor skills, caretaker assistance is required.

This device is:

- ✓ Light weighted
- ✓ Portable
- ✓ Easy to assemble and mount

**Warning!**

This device have been designed to be used as an airplane seat; it is not intended to be used in any other chair or transportation unit (car, train etc.).

## Parts Diagrams:

The AASD consists of two main parts, the legs support, and the upper body support. Figure 1 shows the upper body support diagram.



*Figure 1 Chest Support parts diagram*

## Legs support diagram

The leg support device consists of three parts, A, B, and C. Refer to Figure 1 for details. To assemble the leg support, follow the following steps.

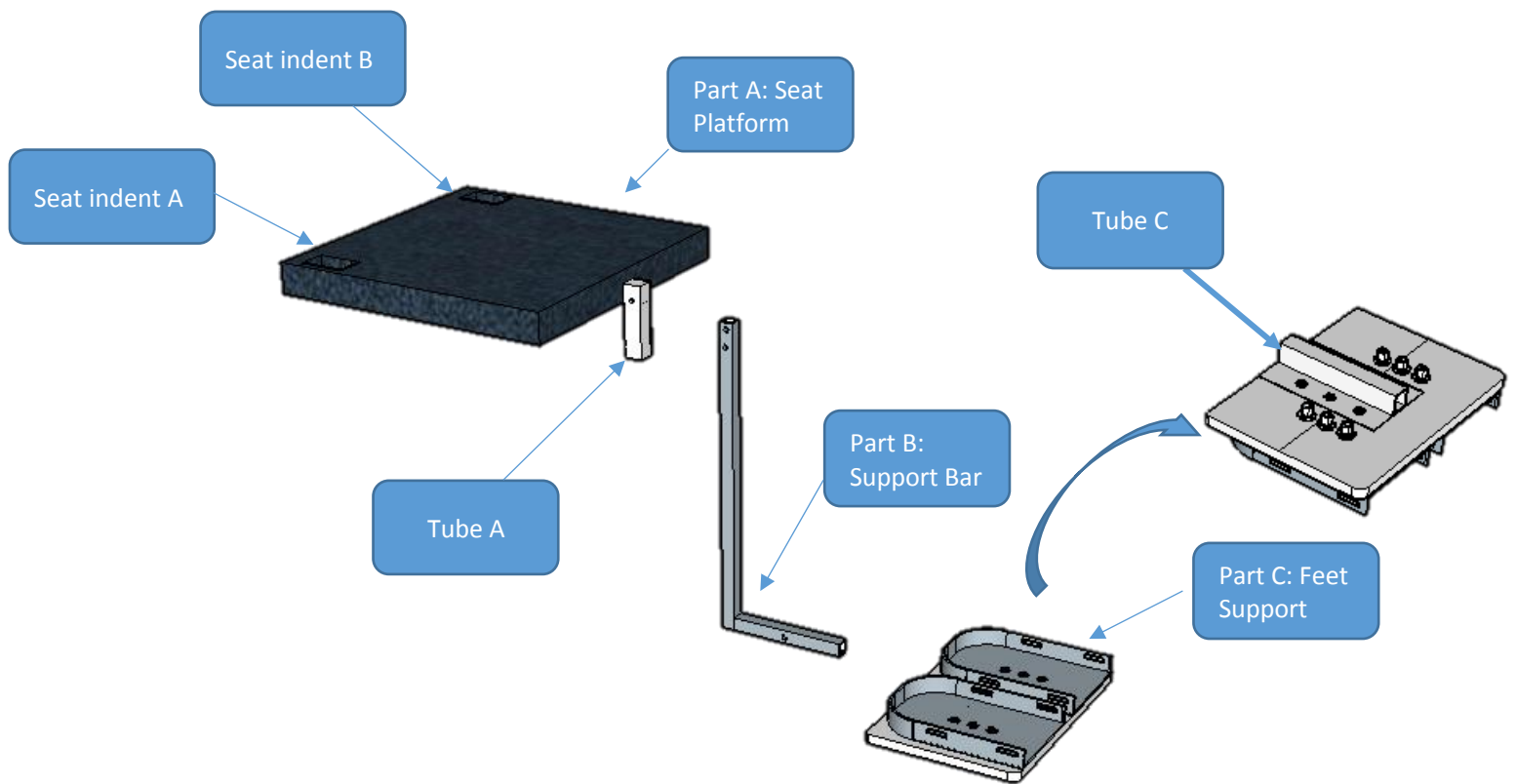

Figure 2 Leg support parts diagram

## Other parts:

Thumb screw and wing nut (2 needed for assembly)



Figure 3 Thumb screw and wing nut

## Leg Support Assembly

Step 1: Seat Platform and support bar join.

Take part A from the bag and put it facing down on a chair, as shown in Figure 4.

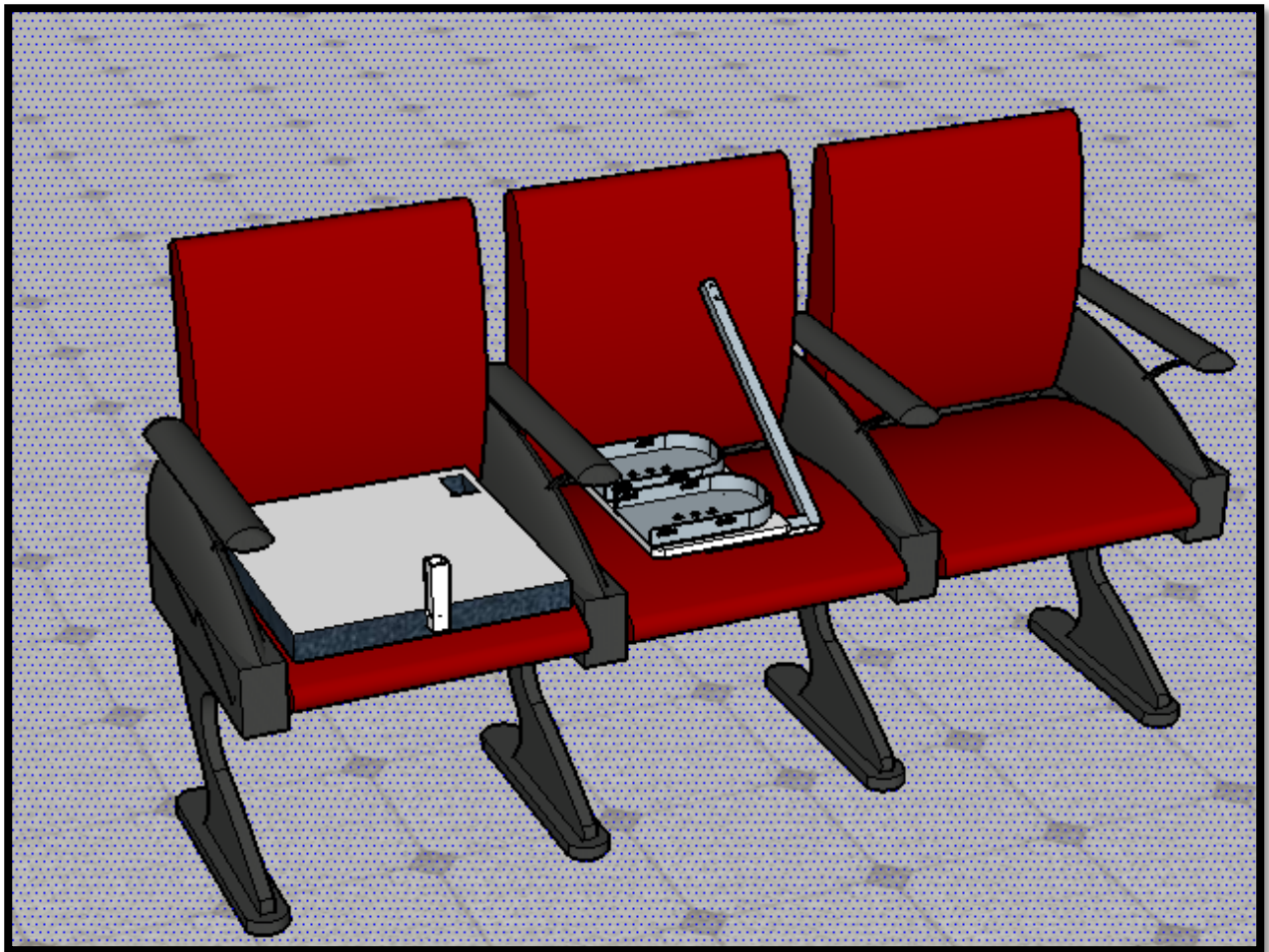
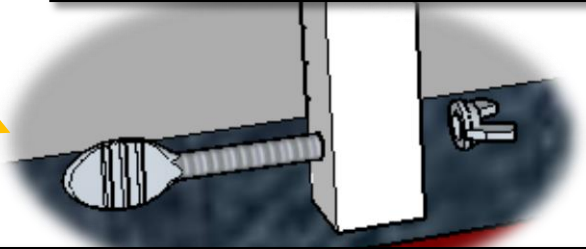
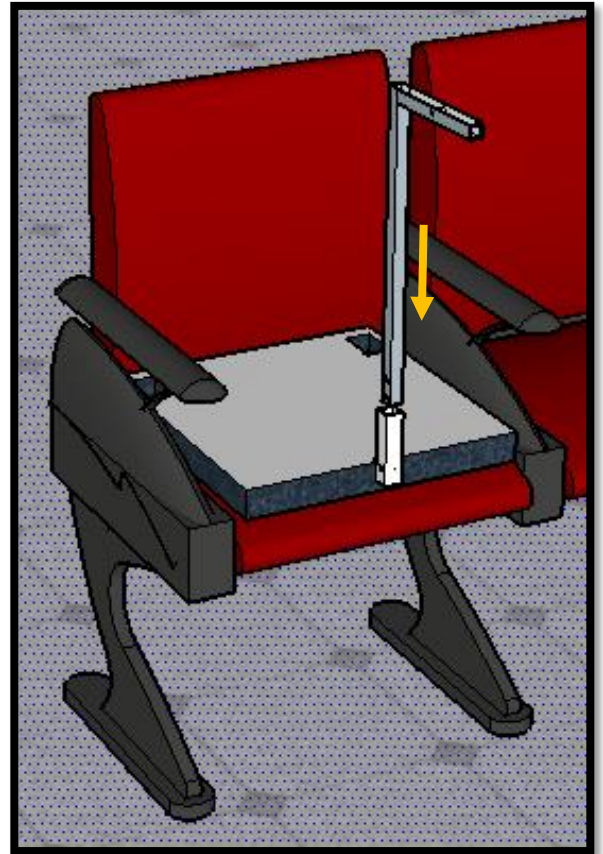
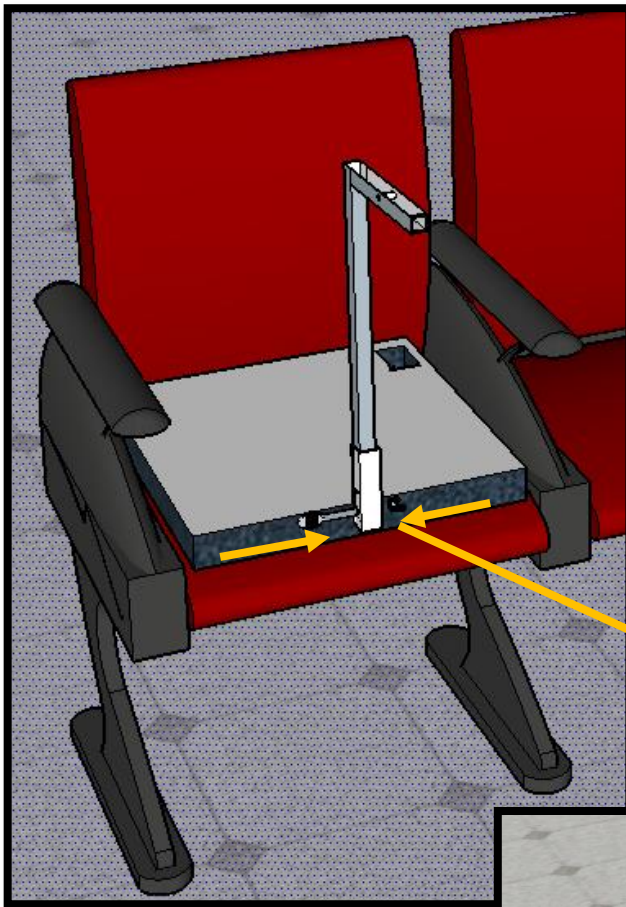

Figure 4 Step 1: Seat Platform and support bar join



**Step 2:**

Insert the longer part of the support bar on tube A, as shown in Figure 3. Make sure that holes 1 and 2 or 1 and 3 (adjust to preferred height) are aligned and pass the screw 1 through both, as shown in Figure 5. Thread at least eight rounds.



**Step 3:**

Insert the shorter end of the support bar on tube C. Refer

*Figure 5 Step 2 diagram*

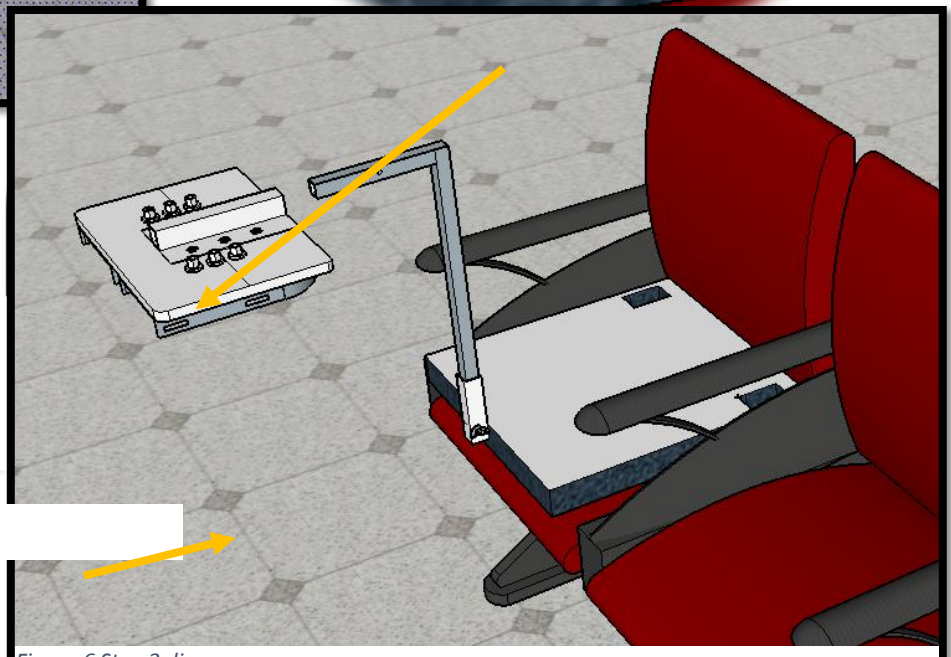

*Figure 6 Step 3 diagram*

to Figure 6. Make sure that holes are aligned and pass a screw A through both, as shown in Figure 7. Thread at least eight rounds.

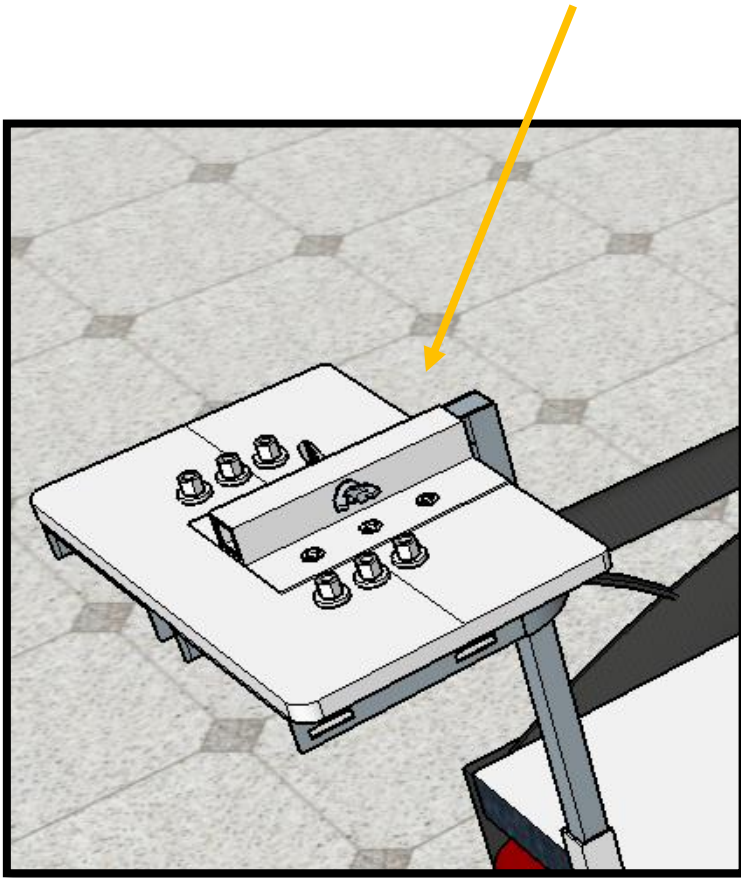

*Figure 7 Thumb screw and wing nut visual*

#### Step 4: Upper Body Assembly

Flip over the product. Insert bottom end of strap A through the seat indent A (Figure 8). Adjust the Velcro strap. Repeat with strap B.

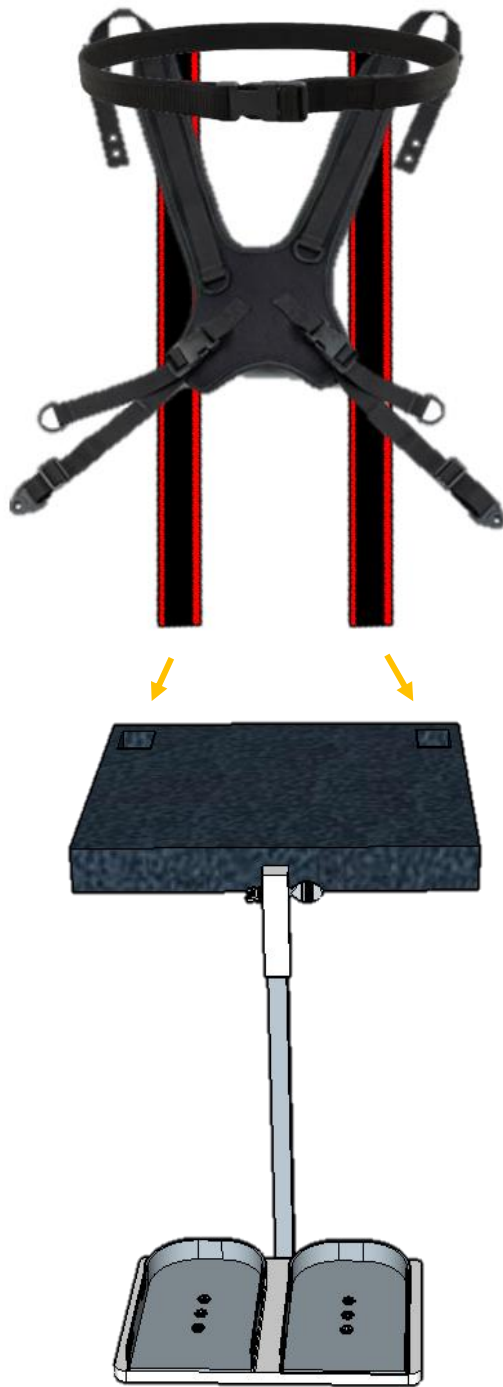

*Figure 8 Upper body assembly diagram*

## Mount Instructions

Step 1: Place the device on the seat.



Step 2: Thread each side of the airplane security belt through indent A and B.

Step 3: Adjust the back seat support belt around the back of the airplane seat. Make sure to tight it. (Open the back passenger tray to pass it around the seat, once it is adjusted, close the tray).

Make any necessary adjustment in the upper body support.

Step 5: Pass the H Belt bottom ends through the airplane security belt.(For steps 1-5, an escort should be with the user at all times).

Step 6: Seat the user in the AASD seat platform.

Step 7: Secure each foot in the feet platform

Step 8: Pass the user's arms through the H belt and secure it.

Step 9: Secure airplane seat belt.